









LEGENDE

-  Fluchtweg Korridor
-  Fluchtweg Treppenhaus
-  Aufstellungsfläche (Auflage beachten)
-  Freizuhalten Fluchtweg
-  interne Treppe
-  Fluchtwegmarkierung selbstleuchtend
-  Fluchtwegmarkierung nachleuchtend
-  Wasserlöschposten Standort / Schlauchlänge in Meter

Kontakt Foyerreservation:
 Frau R.Baca
 Tel.: +41 44 632 05 46
 rosio.baca@akd.ethz.ch

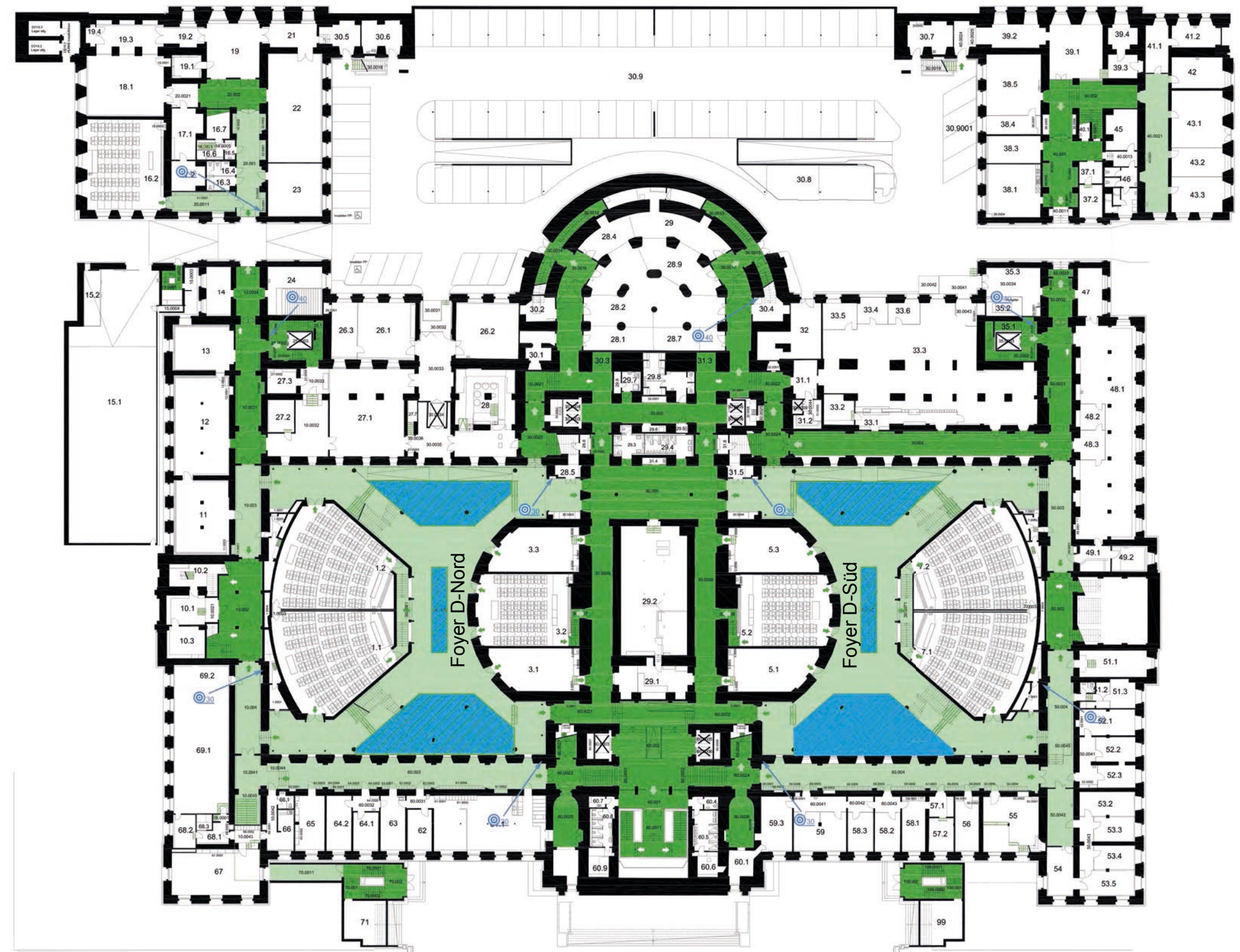

| | |
|---|-------------------------|
| ETH Eidgenössische Technische Hochschule Zürich Swiss Federal Institute of Technology Zurich | HG |
| 1.UG | D-Geschoss |
| Rämistrasse 101 ETH Zentrum | Fluchtwegplan |
| Erstellt: Stab SGU | Datum: 10. Februar 2015 |
| Revision: Stab SGU | Datum: 03. März 2016 |

